



The City of Selma

Historic Riverfront Park Masterplan



Project Features:

Playground (\$508,000): An area used by children for active play with a theme reflecting the cultural and physical history of the site.

Interactive Water Feature (\$356,000): Water feature with interactive jets that invite children and adults to play in the water during the warm months of the year.

Amphitheater (\$579,000): A 2,000 plus person venue accommodating concerts and events located near river with excellent views from seats.

River Walk (\$447,000): A multi-use trail along the river. This feature will connect the major elements of the park together while providing excellent views of the river, Edmund Pettus Bridge and railroad bridge.

Vending/ Concessions : A food service area that would be used to sell food stuffs to visitors and earn revenue for the park.

Pavilion (\$181,000): A large structure that could hold events from weddings and large parties to small concerts and lectures.

Police Precinct (\$567,000): A small area with space for one or two officers to assist park visitors. This will provide a visual police presence to help maintain security in the park deterring bad behavior and increasing safety for visitors.

Historic Selma Carousel (\$1,065,000): Designed with a 'Historic Selma' theme. Instead of having traditional carousel horses, imagery from Selma's past and natural history would be used for the 'horses'.

Restrooms : A facility with appropriate stalls and facilities to meet the anticipated demand within the park.

Market: A space for regularly scheduled markets such as a Saturday farmers market, antique fairs, special exhibits, fairs or similar events.

Boat Dock (\$655,000): A boat dock will allow a place for visitors to come to Selma by boat. This will be a gateway entry point to the city and have connections with multi-use trails to major attractions within the city.

History Feature: Interpretive history element(s) that tell the story of Selma from the earliest settlers to modern times integrated into the overall design and aesthetics of the park.

Parking (\$127,000): A small lot of approximately 50 spaces will be necessary for day to day use. Additional parking for large events and peak use will need to be located off site.

Dog Park (\$77,000): A fenced off leash area for dogs will encourage users of the multi-use trail to linger in the park. Benches and pet waste disposal stations and bag dispensers should be located in the dog park for guest comfort.

Butterfly Garden: In keeping with the 'Butterfly Capital of Alabama' a butterfly garden would provide a contained area for plants that attract butterflies.

Wayfinding: A system of signage to be located throughout the park to enhance the experience for visitors. This system can include large monuments at the main entrances to the park, directional signage, informational kiosks, interpretive signage displaying educational information and site and trailway signage.

Site Amenities: Benches, tables, chairs, trash receptacles, water fountains, area lights, path lights, and other features that tie the aesthetic character of the park together through repeated use in the park.

Donor Feature: A sculpture, wall, tower, fountain or other feature with space to recognize major donors to the park. The feature is to be integrated into the overall character and aesthetics in the park while providing appropriate recognition to those who provide extra ordinary support for the park.

History:

Continuing efforts from the City of Selma Government, Gresham, Smith and Partners was hired by the city of Selma in 2008 to complete a Masterplan Study for a proposed Historic Riverfront Park. This park is proposed to be located on an approximately 12 acre area in the City of Selma between The Alabama River and Businesses on Water Avenue. Gresham, Smith and Partners worked closely with city officials and a committee of local citizens and business owners as part of a process to analyze the proposed site, develop a program, and create a masterplan that fits the needs of the citizens of Selma and businesses located adjacent to the proposed park and in Downtown Selma. The results of this collaboration created the Masterplan which is to act as a guide for how the area of the proposed park can be developed and provide a park that will be a cherished feature in the City of Selma for generations to come.

For Further Information Please Contact:

City of Selma
George Evans, Mayor

Department of Planning and Development
Charlotte Griffeth, Director
Patty Sexton, Project Manager

PO Box 450
Selma, Alabama 36702

Phone: (334) 874•2111 Fax: (334) 874•2117

E-mail: planningdevelopment@selma-al.gov



The City of Selma

Aerial Perspective



Plan View



Carousel and Bosquet Courtyard

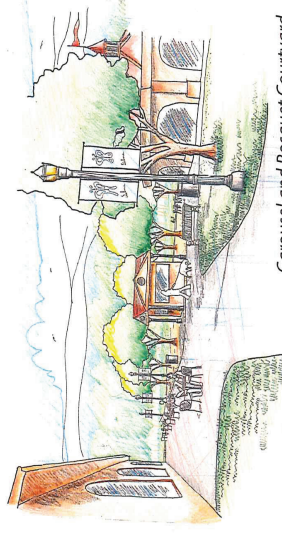

Interactive Fountain



View of Boat Dock

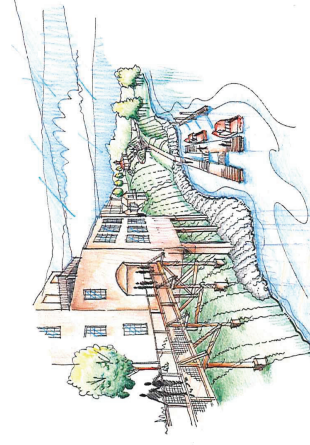

View from Bridge Tender's House

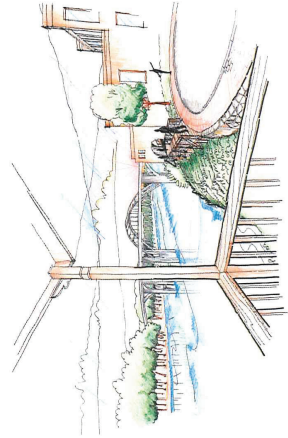

Selma Riverfront Park

Conceptual Masterplan

